

Paramount Emotion Floor Plan

2 BHK + 2T Super Area 950 Sqft

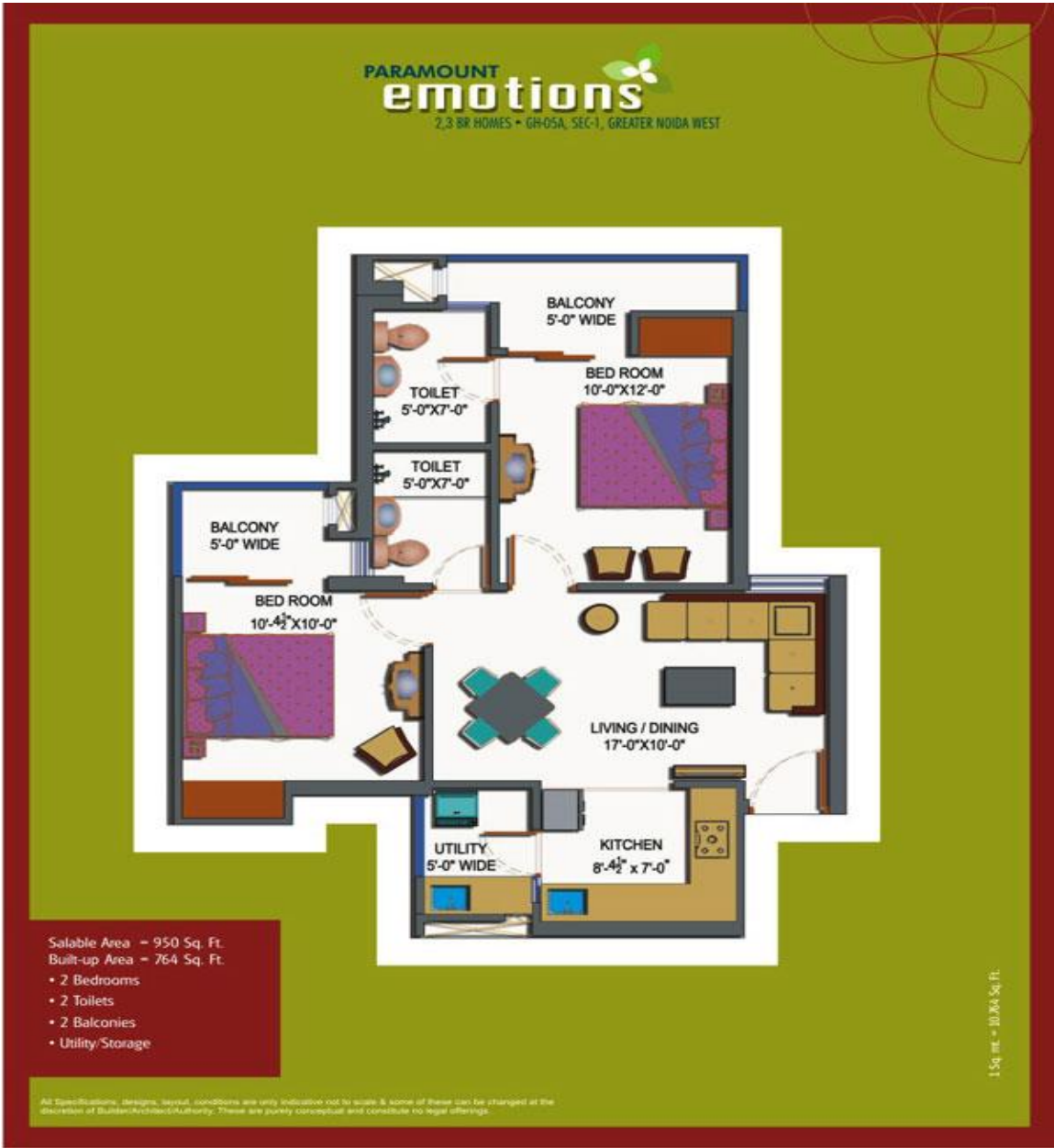

2 BHK + 2T Super Area 1075 Sqft

PARAMOUNT
emotions
2,3 BR HOMES • GH-05A, SEC-1, GREATER NOIDA WEST



- Salable Area = 1075 Sq. Ft. (Large)
Built-up Area = 867 Sq. Ft.
• 2 Bedrooms
• 2 Toilets
• 2 Balconies
• Utility/Storage

1 Sq. mt. = 10.764 Sq. Ft.

All Specifications, designs, layout, conditions are only indicative not to scale & some of these can be changed at the discretion of Builder/Architect/Authority. These are purely conceptual and constitute no legal offerings.

3 BHK + 2T Super Area 1160 Sqft

PARAMOUNT
emotions
2,3 BR HOMES • GHOSA, SEC-1, GREATER NOIDA WEST



- Salable Area = 1160 Sq. Ft. (Small)
Built-up Area = 933 Sq. Ft.
- 3 Bedrooms
 - 2 Toilets
 - 3 Balconies
 - Utility Storage

All Specifications, designs, layout, conditions are only indicative not to scale & some of these can be changed at the discretion of Builder/Architect/Authority. These are purely conceptual and constitute no legal offerings.

1 Sq. mt. = 10.764 Sq. Ft.

3 BHK + 3T Super Area 1520 Sqft

PARAMOUNT
emotions
2,3 BR HOMES • GHOSA, SEC-1, GREATER NOIDA WEST

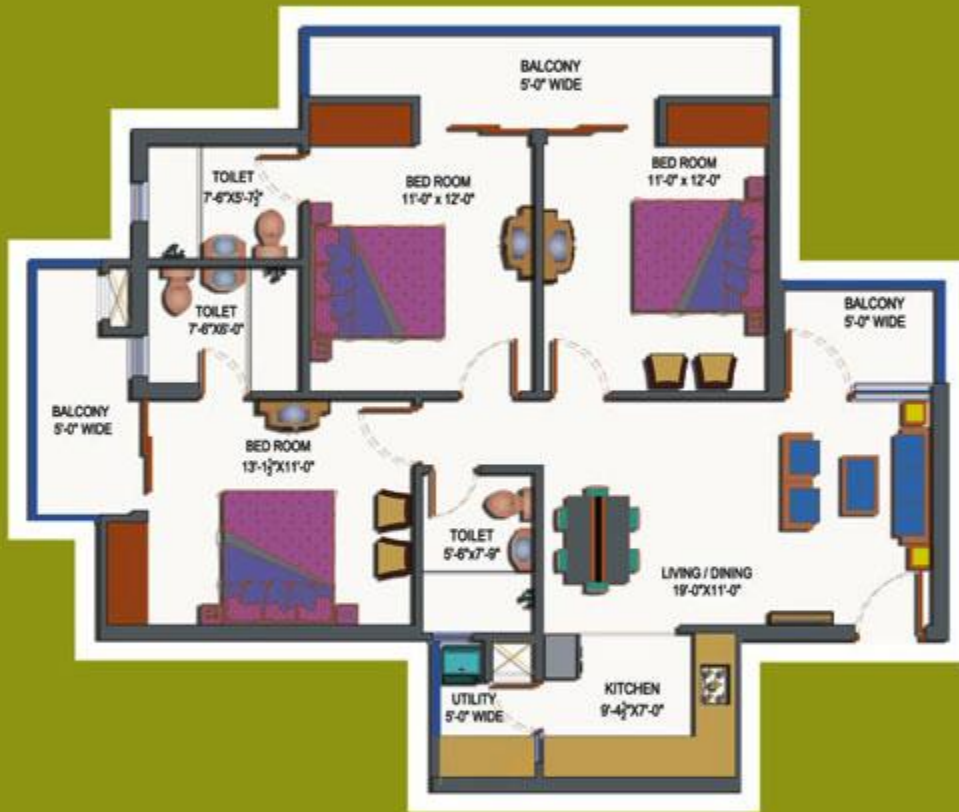

- Salable Area = 1520 Sq. Ft.
Built-up Area = 1224 Sq. Ft.
- 3 Bedrooms
 - 3 Toilets
 - 3 Balconies
 - Utility/Storage

1 Sq. mt. = 10.764 Sq. Ft.

All Specifications, designs, layout, conditions are only indicative not to scale & some of these can be changed at the discretion of Builder/Architect/Authority. These are purely conceptual and constitute no legal offerings.

3 BHK + 4T + Ser Super Area 1710 Sqft

PARAMOUNT
emotions

2,3 BR HOMES • GH-05A, SEC-1, GREATER NOIDA WEST



Salable Area - 1710 Sq. Ft.
Built-up Area - 1381 Sq. Ft.

- 3 Bedrooms
- 4 Toilets
- 4 Balconies + Dress + Servant
- Utility/Storage

All Specifications, designs, layout, conditions are only indicative not to scale & some of these can be changed at the discretion of Builder/Architect/Authority. These are purely conceptual and constitute no legal offerings.

1 Sq. mt. = 10.764 Sq. Ft.

3 BHK + 2T Super Area 1380 Sqft

PARAMOUNT
emotions
2,3 BR HOMES • GH-05A, SEC-1, GREATER NOIDA WEST



Salable Area = 1380 Sq. Ft. (Large)
Built-up Area = 1111 Sq. Ft.

- 3 Bedrooms
- 2 Toilets
- 4 Balconies
- Utility/Storage

All Specifications, designs, layout, conditions are only indicative not to scale & some of these can be changed at the discretion of Builder/Architect/Authority. These are purely conceptual and constitute no legal offerings.

1 Sq. mt. = 10.764 Sq. Ft.